

m

FIELD SHEET

DATE 23.03.2017 LOCATION vesturgata / Hjarjarholt

WEATHER 2°C ROAD SURFACE CONDITIONS \_\_\_\_\_ TIME TO 715 - 730

INDICATE NORTH BY ARROW

RIGHT STRAIGHT LEFT

LEFT RIGHT

STRAIGHT STRAIGHT

V.gata V.gata

RIGHT LEFT

LEFT STRAIGHT RIGHT

RECORDER

Motor Vehicle Volume Field Sheet

S = senderferbill

DATE 23.03.2017 FIELD SHEET LOCATION Vestergata / Hjørterholt  
WEATHER 2°C ROAD SURFACE CONDITIONS \_\_\_\_\_ TIME TO FROM 730-745

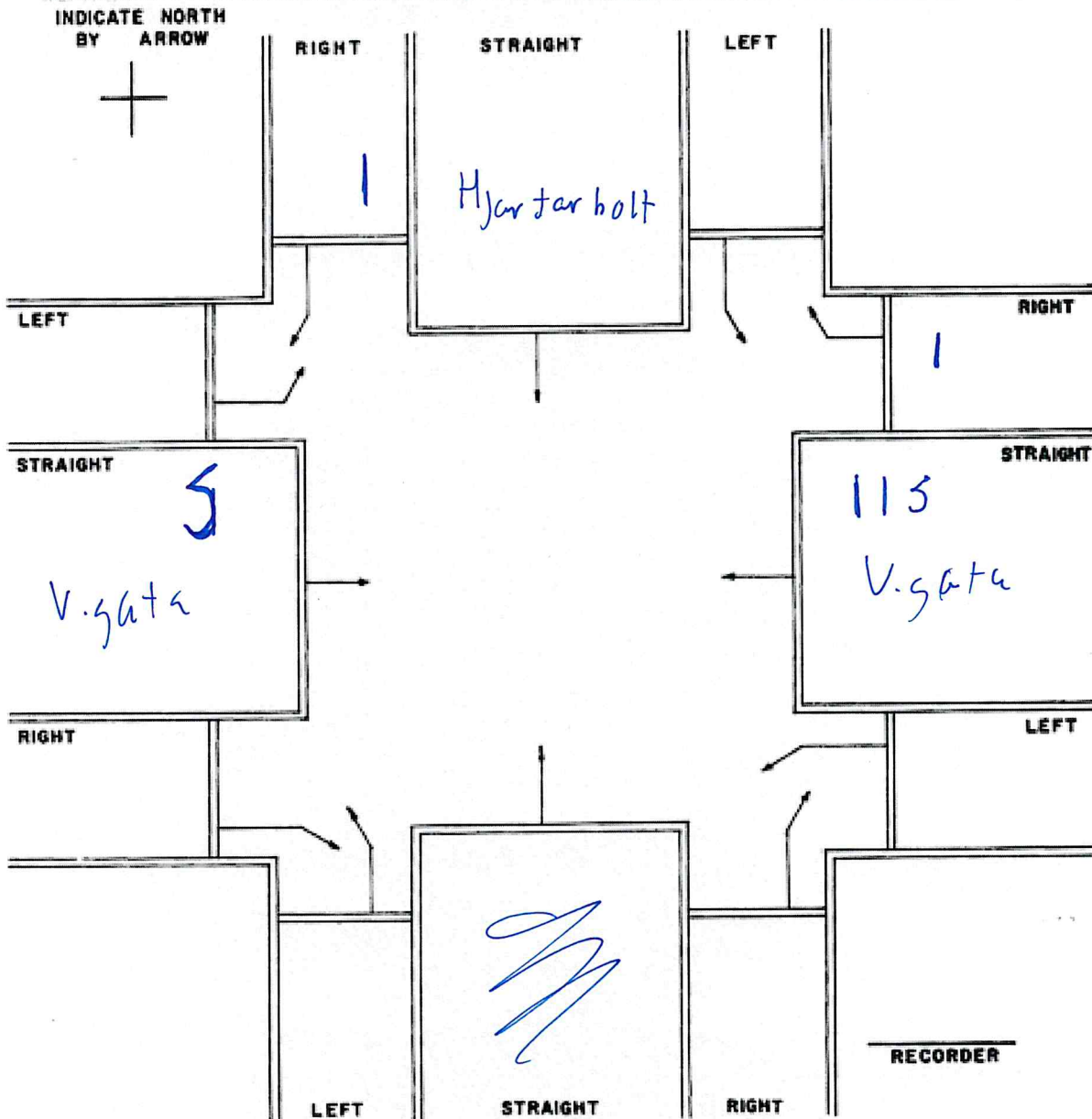

Motor Vehicle Volume Field Sheet

DATE 23.03.2017 FIELD SHEET LOCATION Vester gate / Hjørterholt

WEATHER 2°C ROAD SURFACE CONDITIONS \_\_\_\_\_ TIME TO \_\_\_\_\_ FROM 8:00-8:30 745-800

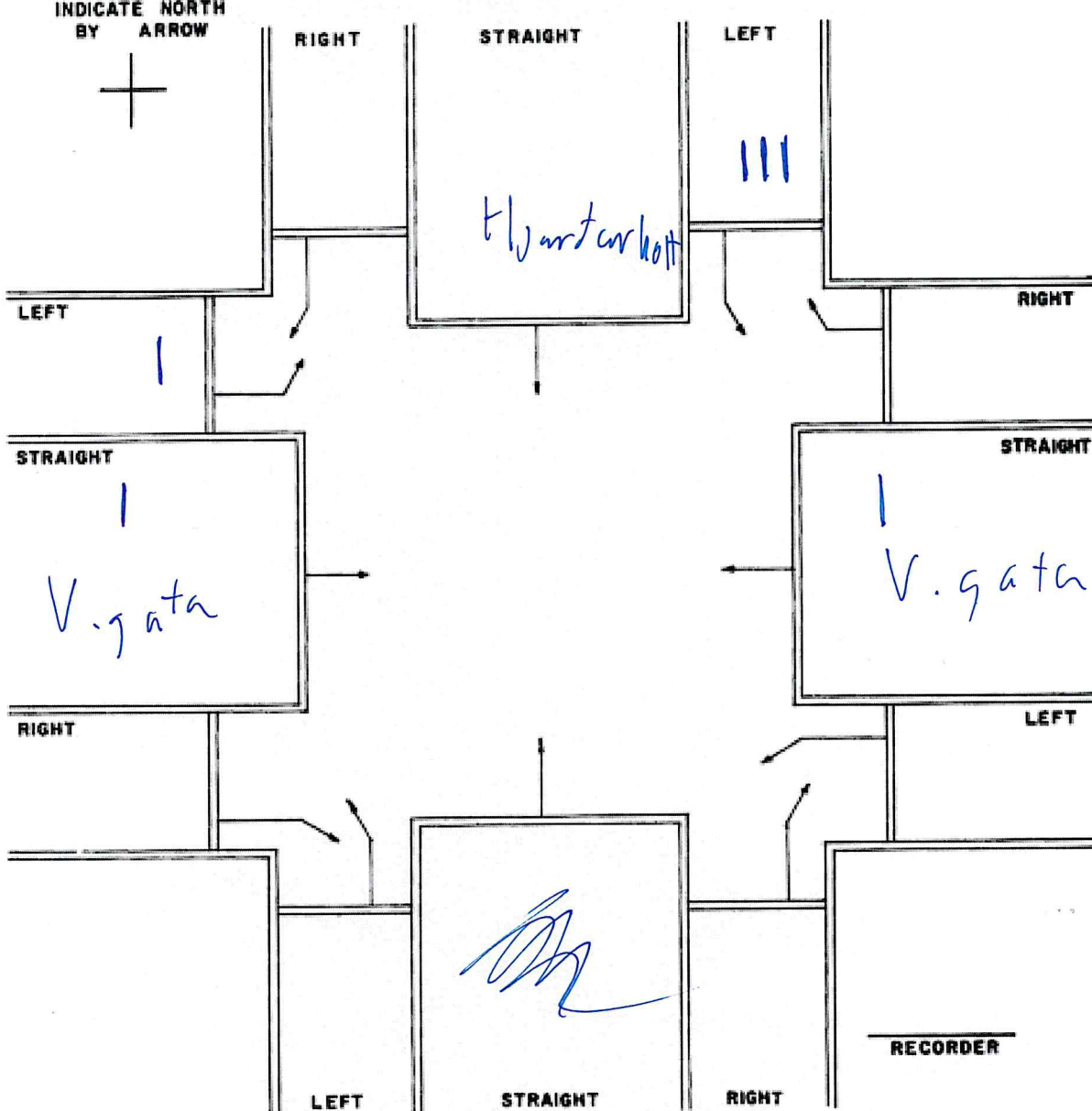

Motor Vehicle Volume Field Sheet

DATE 23.03.2017 FIELD SHEET LOCATION Vester gata / Hjørterholt  
 WEATHER 2°C ROAD SURFACE CONDITIONS \_\_\_\_\_ TIME TO FROM 800 - 815

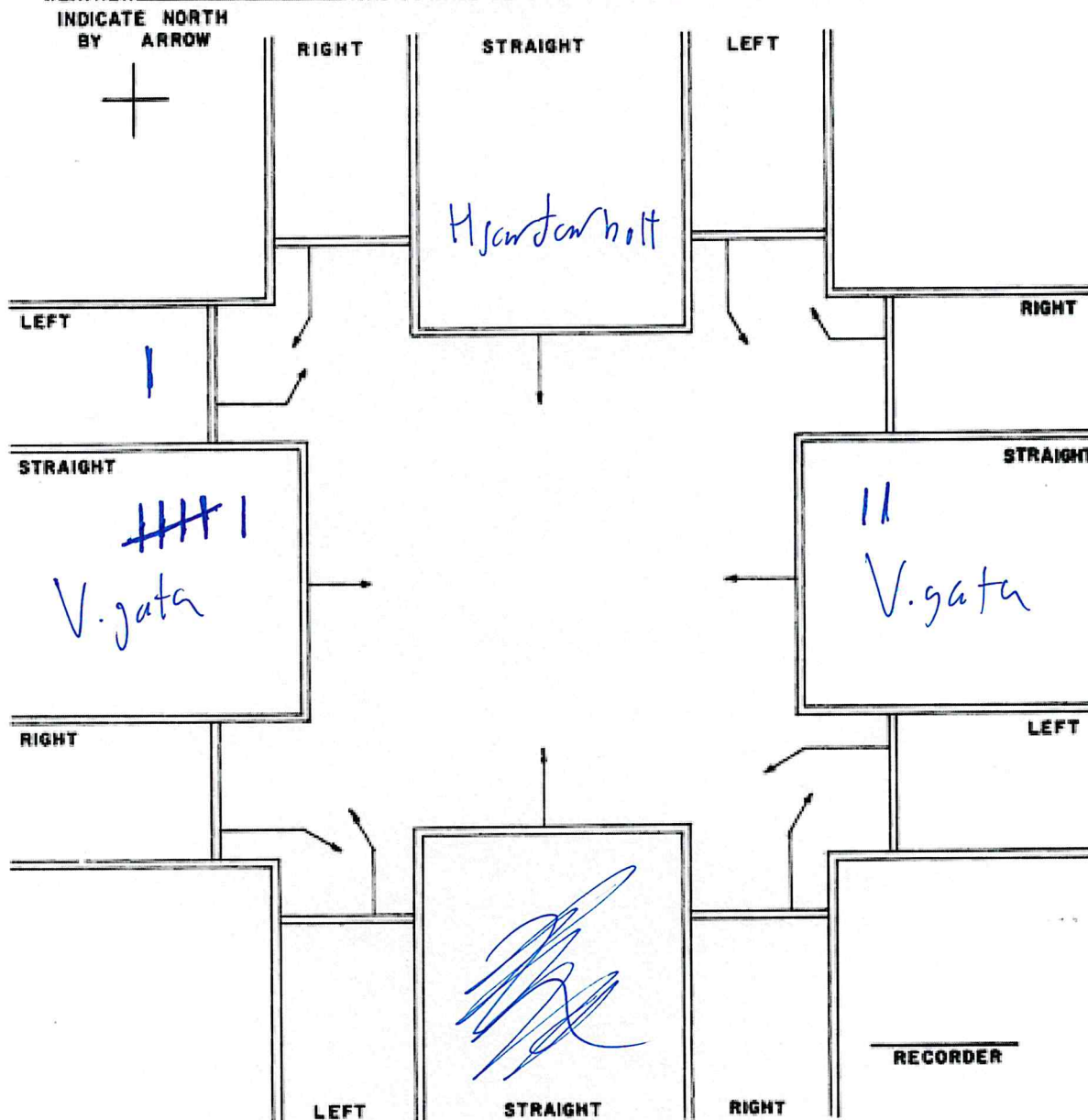

Motor Vehicle Volume Field Sheet

DATE 23.03.2017 FIELD SHEET LOCATION Vestvæta / Myrjarholt  
 WEATHER 2°C ROAD SURFACE CONDITIONS \_\_\_\_\_ TIME TO 8:15 - 8:30

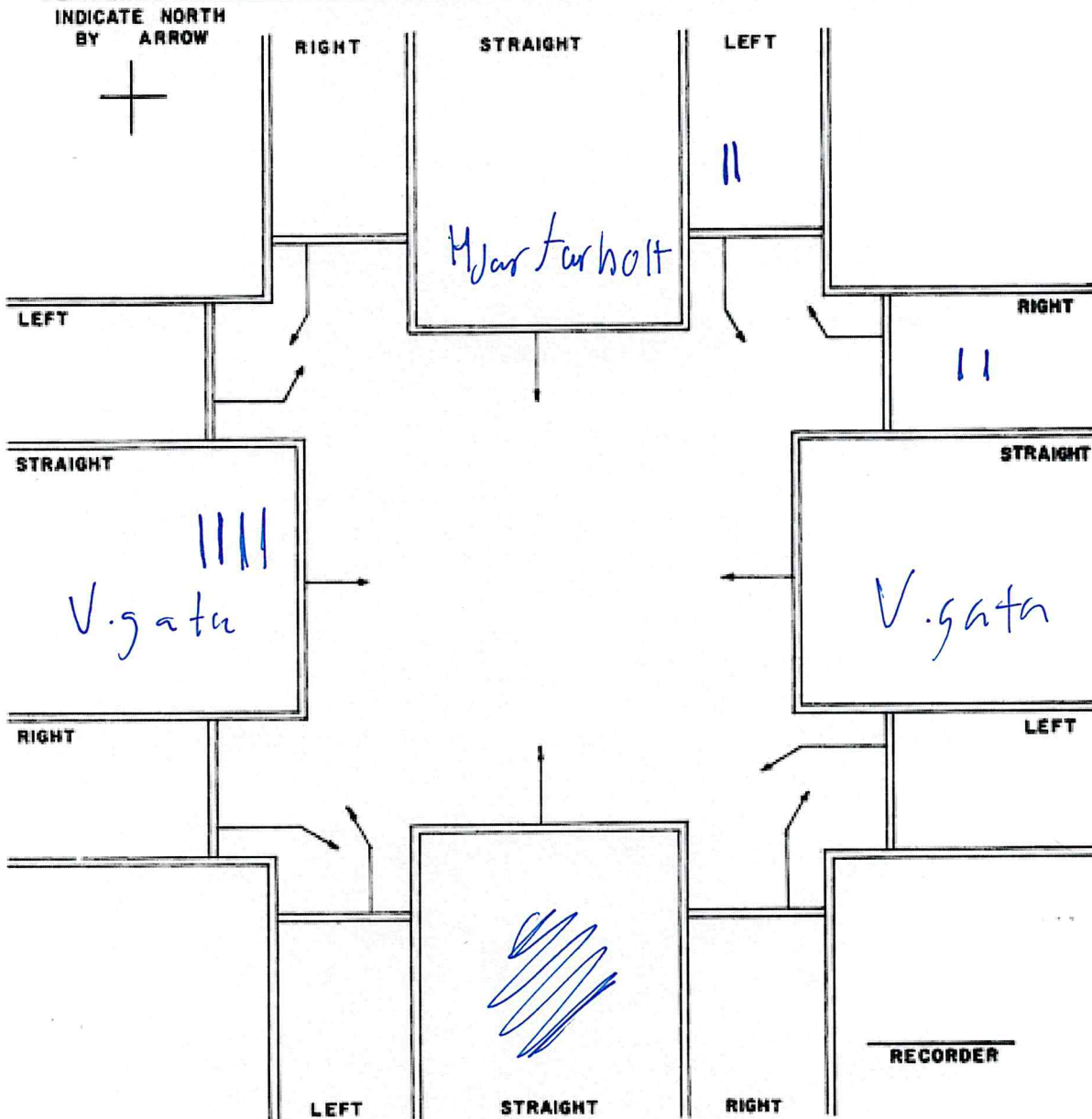

Motor Vehicle Volume Field Sheet



T = Truck

DATE 23.03.2017 FIELD SHEET LOCATION Vestergata / Mjorsterholt  
WEATHER 3°C ROAD SURFACE CONDITIONS \_\_\_\_\_ TIME TO 8:30 - 8:45  
INDICATE NORTH BY ARROW 

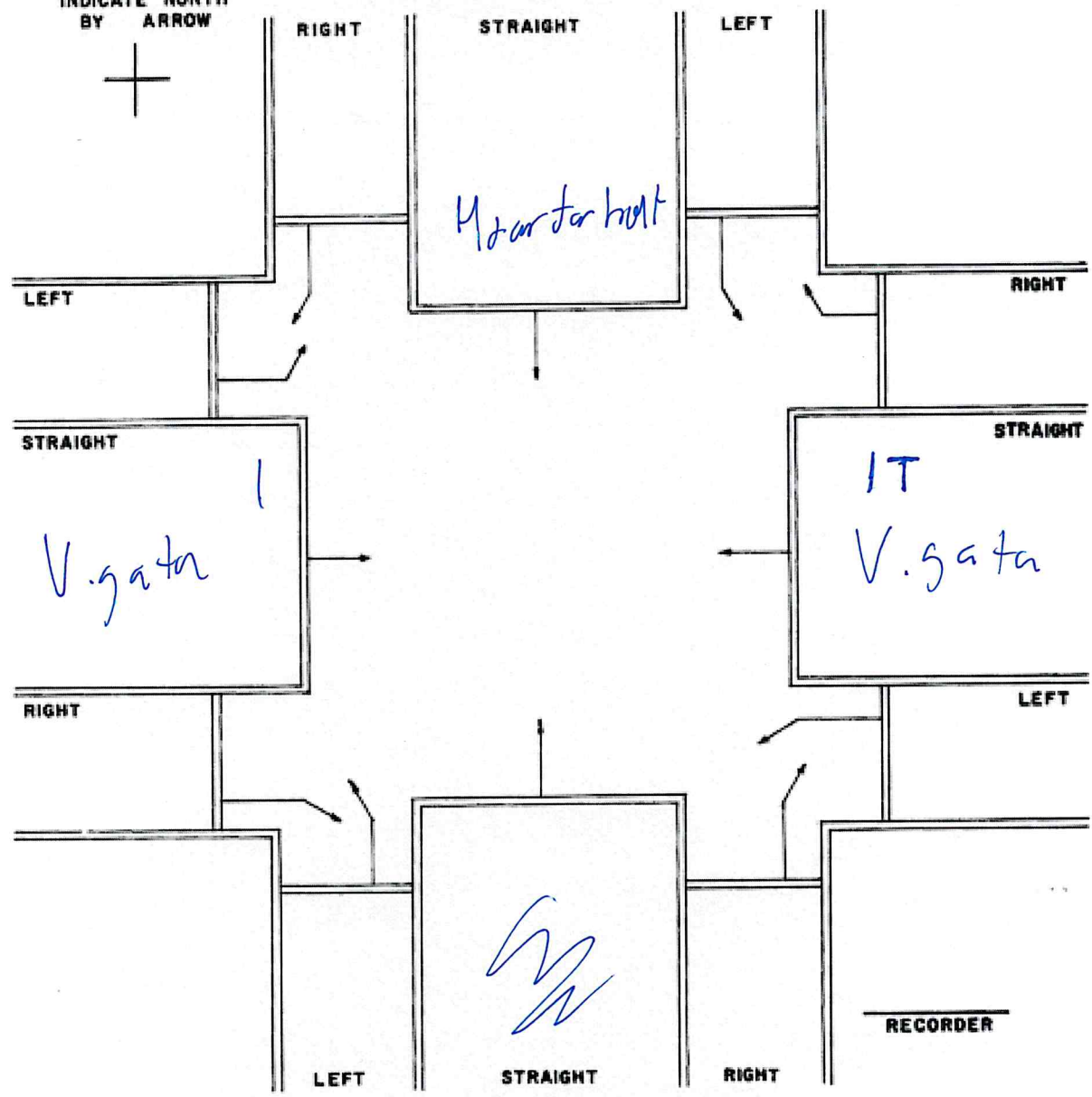

RIGHT STRAIGHT LEFT  
Mjorsterholt  
LEFT RIGHT  
STRAIGHT STRAIGHT  
Vestergata IT Vestergata  
RIGHT LEFT  
LEFT STRAIGHT RIGHT  
RECORDER

Motor Vehicle Volume Field Sheet

FIELD SHEET  
 DATE 23.05.2017 LOCATION Vestergata / Hjorteholt  
 WEATHER 3°C ROAD SURFACE CONDITIONS \_\_\_\_\_ TIME TO FROM 8:45 - 9:00

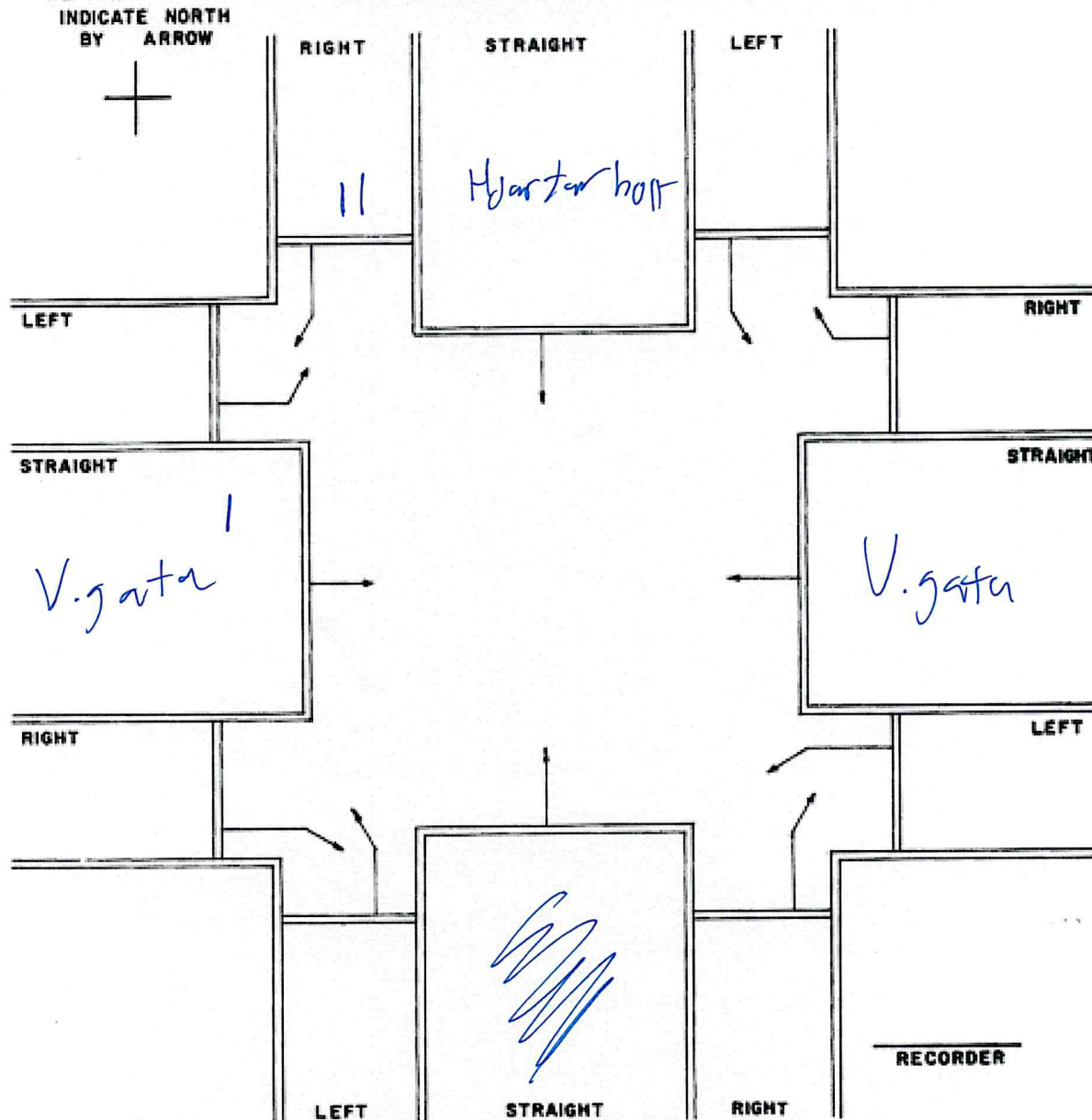

Motor Vehicle Volume Field Sheet